

Date: 2023-10-30
 Enquiry dated:
 Project:
 Quotation-no.:
 Item:
 Reference:



Evaporator (dx) GHN 090.2H/17-EHD50.E For calculation only!

Capacity:	62.8 kW ⁽¹⁾	Refrigerant:	R404A ⁽²⁾
Surface reserve:	0.1 %	Evaporation temp.:	-8.0 °C
Air flow:	29450 m ³ /h	Superheating:	5.0 K
Air inlet:	0.0 °C	Condensing temp.:	35.0 °C
Air outlet:	-5.0 °C	Subcooled temp.:	29.6 °C
Air pressure:	1013 mbar		
Fans:	1 Piece(s) 3~400V 50HzΔ/(Y)	Thermal contact:	external
Data per motor (nominal data):		Noise pressure level:	66 dB(A) in 3.0 m ⁽³⁾
Speed:	890 min ⁻¹ / (700 min ⁻¹)	Noise power level:	89 dB(A)
Capacity (mech./el.):	2.79 kW/3.60 kW	Air throw:	approx. 53 m ⁽⁴⁾
Current:	7.20 A ⁽⁵⁾	Frost:	0.0 mm
ErP:	Compliant ⁽⁶⁾		
Total el. power consumption:	3.59 kW	Energy efficiency class:	D (2014)
Casing:	Galv. Steel, Powder coated RAL 9003	 Tubes:	Copper ⁽⁷⁾
Surface:	305.3 m ²	 Fins:	Aluminum ⁽⁷⁾
Tube volume:	87.4 l	 Distr. press. drop:	1.4 bar
Fin spacing:	7.00 mm	 Outlet connection:	76.1 * 3.00 mm
Dry weight:	576 kg ⁽⁸⁾	 Inlet connection:	35.0 mm
Max. operating pressure:	32.0 bar	 PED classification:	Category I, module A ⁽⁹⁾

Dimensions:

- L = 2510 mm
- B = 1220 mm
- H = 1560 mm
- E = 1800 mm
- F = 990 mm
- C = 460 mm
- A = 900 mm
- ØD = 18 mm
- K = G2

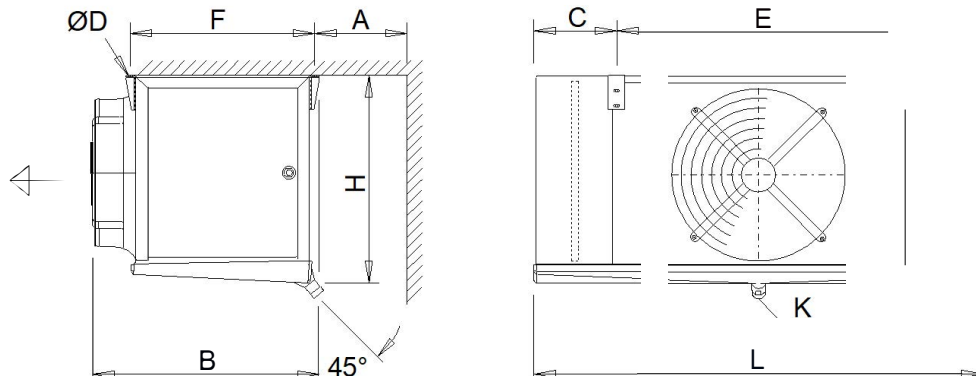

Drain according to DIN ISO 228-1 with G-thread (flat gasket).
 Attention: Drawing and dimensions not valid for all accessory options!

Important remarks / explanatory notes:

- (1) Capacity according to Eurovent
- (2) Fluid group 2 according to pressure equipment directive 97/23/EG and directive 67/548/EWG
- (3) According to the standard procedure for measuring the sound pressure levels defined in EN 13487, the Eurovent tolerance = +2 dB(A) only applies for AC fans with sine control or EC fans; noise caused by other control procedures or water spraying systems are not taken into account.
- (4) Distance at which an air velocity of 0.5 m/s can still be measured isothermally in an ideal space. The achievable penetration depth of the air flow in the cold room depends on the spatial geometry and other factors.
- (5) The current consumption can differ in dependence of the air temperature and of the variations of system voltage according to the VDE guidance.
- (6) This unit is equipped with fans that meet the efficiency requirements of Directive 2009/125/EC (ErP Directive).
- (7) The unit may not be suitable for very corrosive atmospheres (close to shores, in smoke rooms, etc.). For further information see program menu "?", "Material recommendations brochure", or ask your sales partner.
- (8) Dimensions and weights are not valid for all possible options! They may differ for units with accessories or special units (S-...).
- (9) Piping (DN = 81.7 mm, T_{Smax} = 100 °C, gaseous). Final classification according to pressure equipment directive 97/23/EC during order processing.
- (10) Fuse protection according to connected load on connection diagram, max. 25 A

Please pay attention ...

The unit is only for calculation:

The prices are no longer valid.